

Maschine wird auf Fundament entsprechender Qualitaet aufgestellt (Baufachmann)
 Installation of machine on a foundation of appropriate quality (building expert)

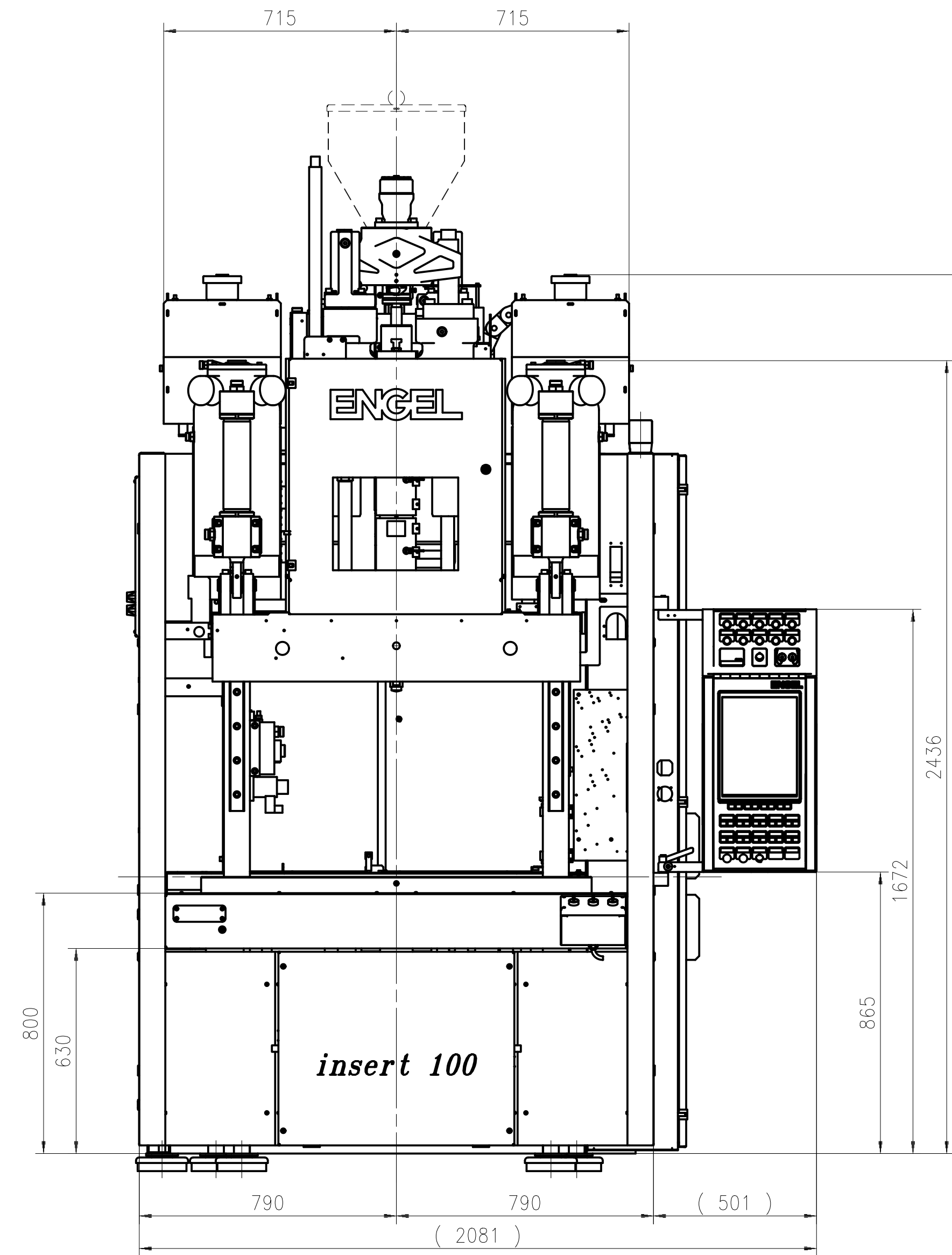

- A Elektroanschluss
main connexion
- B Kuehlwasser - Zulauf/Schlauchstueck 1"
cooling water-inlet/hosepipe 1"
- C Kuehlwasser - Ablauf/Schlauchstueck 1"
cooling water outlet/hosepipe 1"
- D Druckluftanschluss 3/8"
pressure air conection 3/8"
- E Transportvorrichtung
transport-device

Oeleinfaellmenge
 Haupttank 198L
 Nachsaugtank 2x31L
 oil filling of hydraulic system
 Main tank 198L
 Prefill 2x31L

Option	zus. Gewicht add weight (kg)	
	Maschine	Modul
Oilfuellung/oil filling	220	-
Zusatzschaltschrank/add elec cabinet	-	100
SHV2	-	150
Akku/accu	50	30
-	-	-
-	-	-

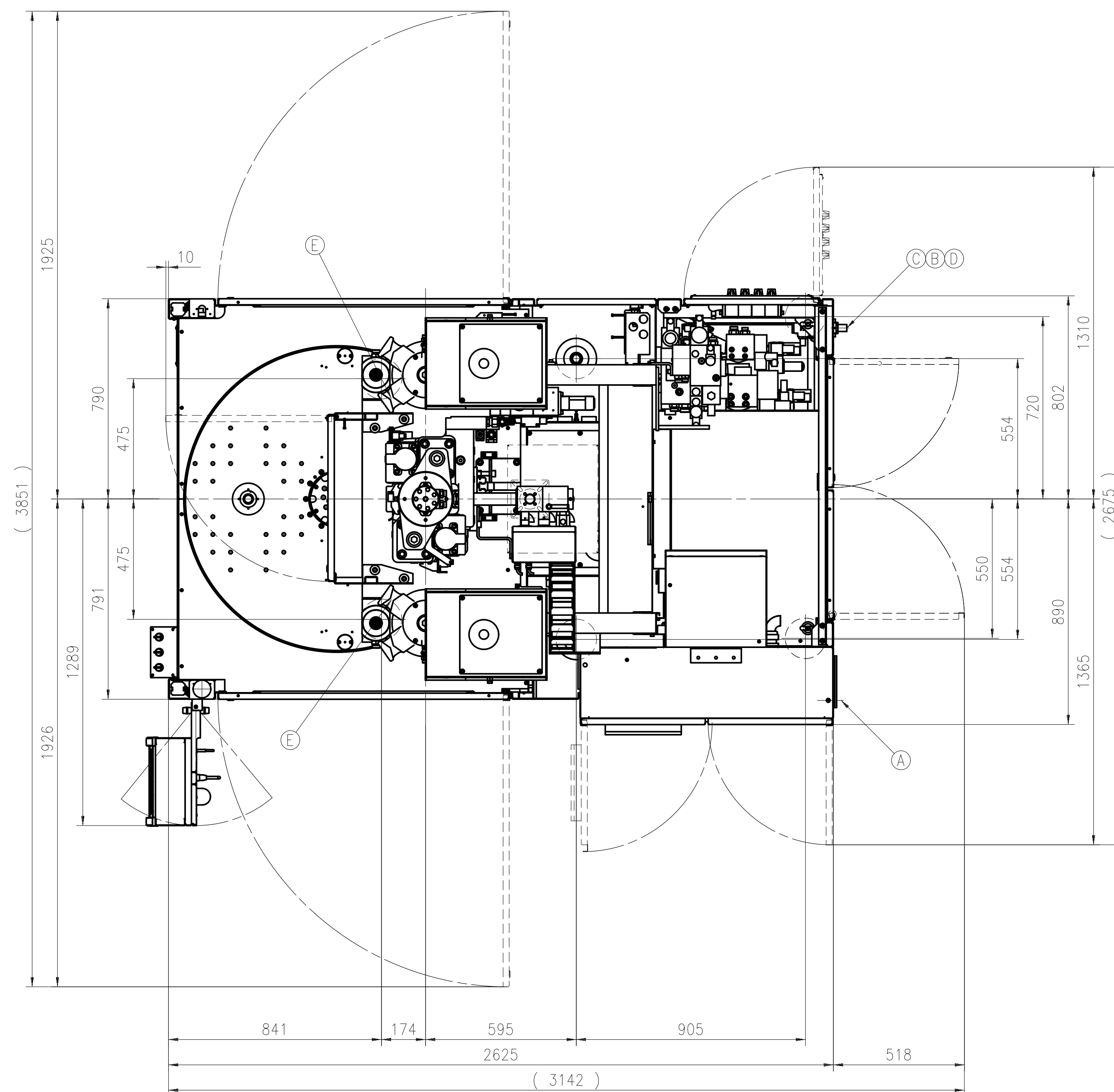

TYPE	Massezylinder Schnecken Ø Screw diameter	H (mm)	H0 (mm)	H1 (mm)	H2 (mm)	H3 (mm)	H4 (mm)	Gesamtgewicht machine weight total (kg)
IN 80V/100	18, 22, 25	2596	2596	2347	3076	3275	3213	7900
IN 200V/100	25, 30, 35	2806	2925	2557	3476	3635	3538	8000
IN 330V/100	30, 35, 40	3013	3063	2685	3673	3768	3777	8250
IN 500V/100	35	3101	3101	2685	3801	3768	3833	8300
IN 500V/100	40	3201	3201	2785	3901	3868	3933	8300
IN 500V/100	45	3301	3301	2885	4001	3968	4033	8300

Pneum.Verschlussduese/pneum.shutoff nozzle: Hx +113mm
 Nadelverschlussduese/pin shutoff nozzle : Hx +75mm

DESCRIPTION/DESCRIPTION MAIN DIMENSION DRAWING IN-V/100 (TR) FUNDAMENTPLAN IN-V/100 (TR)		REV. NO./REV. 00	SHEET NO./BLATT NR. 1/1
DRAWING NO./ZNR. 4894-904-23-01-010		DOC. STAT./DOC. STAT. FR	DATE/DATE 2010-12-27
APPL. STD./NTR./NORM ETR10009 ISO 8015 ISO 2768-mK	ISO 1302 (1993)	OFFICE/ABT./NAME 51008007WJH	COPY FROM/ANS. ZNR. -
MATERIAL/WERKST. ENGL. AUSTRIA	MATERIAL/WERKST. ENGL. NORTH AMERICA	MATERIAL/WERKST. ENGL. KOREA	
ACC. TO/GENMESS	ACC. TO/GENMESS	ACC. TO/GENMESS	

REPRODUCTION, DISTRIBUTION AND UTILIZATION OF THIS DOCUMENT AS WELL AS COMMUNICATION OF ITS CONTENTS TO OTHERS WITHOUT EXPRESS AUTHORIZATION FROM ENGEL IS PROHIBITED. ALL RIGHTS RESERVED. COPYRIGHT © ENGEL. REPRODUCED SOME VERIFIED/ALGUNOS SIEMPRE DOCUMENTOS. VERIFICACION Y UTILIZACION DE ESTOS DATOS SIN PERMISO. STRICTLY PROHIBITED. ALL RIGHTS RESERVED. REPRODUKTION UND NUTZUNG OHNE ZUGESTIMMUNG VON ENGEL IST VERBODEN. ALLE RECHT. SCHAUTUNGEN. ZUGESTIMMUNG VON ENGEL.

ENGEL